

## Rinnai EnergySaver® Direct Vent Wall Furnace

Efficient Supplemental Heating for Homeowners



**Comfortable heat for hard-to-heat spaces**

Transform any living space — from basement to sunroom, or even the whole home — with self-adjusting heat that keeps room temperature consistent, from floor to ceiling.

### Consistent Warmth and Reduced Cold Spots

- Maintains pre-set temperature
- Distributes heat evenly

### Energy Efficient Solutions

- Unique energy-saving modulating technology intuitively matches the specific level of heat needed at any given moment, responding to the smallest temperature changes (within 2 in /5 cm above the floor)
- Rinnai offers multiple models for just the right size and configuration to heat a whole home or complement an existing heating system
- Complements existing heating solutions
- Minimizes heat loss with no ductwork

### The Rinnai Difference



**Consistent, Even Heat**



**Wall Thermostat Compatible**



**Modulating Technology**



**User-Friendly Controls**



**Versatile Installation Options**



**High-Altitude Approved**

### Customized Heating

The easy-to-use programmable thermostat lets you set a comfortable temperature for when you're home and a lower setting for when you're gone. Attach to a Wi-Fi enabled thermostat (Nest, Honeywell, Ecobee, etc.) for additional flexibility and comfort, meeting supplemental or specific zone heating needs.

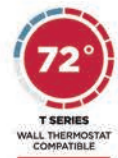

**USER-FRIENDLY CONTROL PANEL**  
Manage the temperature in your home with our user-friendly control panel. Simply choose a set temperature or customize heating during the day by programming the timers.

STREAMLINE DESIGN | NATURAL GAS OR PROPANE MODELS | EASY INSTALLATION



**she shed**

OR GARAGE SPACE



**man cave**

OR BASEMENT REMODEL



**sun room**

OR ENCLOSED PORCH



**cabin**

OR LAKE HOUSE

## Quick, Flexible Installation

Rinnai EnergySaver® Direct Vent Wall Furnaces provide quick installation, and flexible venting allows positioning along almost any outside wall.

## Venting Options

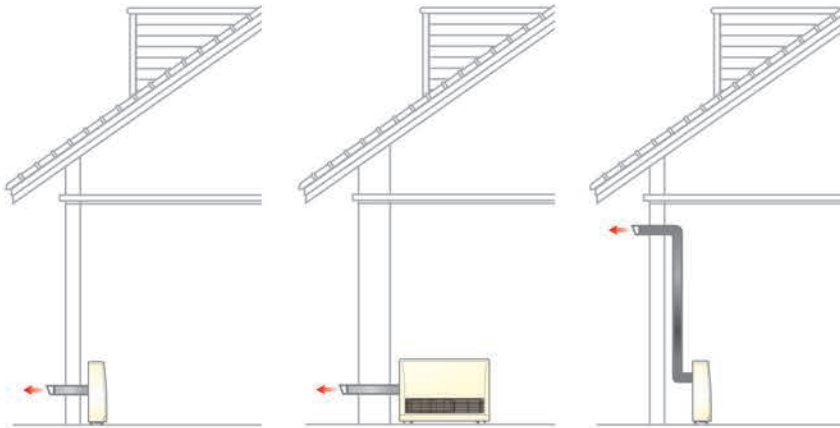

**Direct, Through-Wall Vent Termination**

**Through-Wall Vent Termination with Extension Kit**

**Through-Wall Vent Termination with Extension Kit and Elbow**

Please consult the Owner's Operation and Installation Manual for installation requirements.

## RINNAI ENERGY-SAVING MODULATING TECHNOLOGY

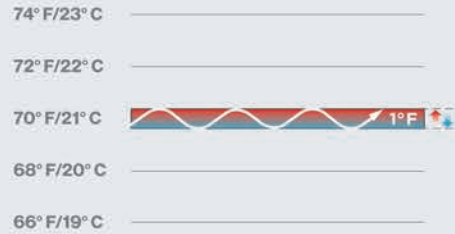

Rinnai's technology responds to small temperature changes, resulting in higher levels of comfort.

## STANDARD SPACE HEATER (ON/OFF)

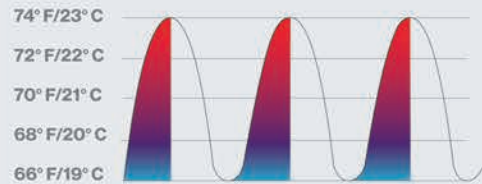

On/Off Cycle of a Standard Space Heating Appliance.

## MODEL CHART AND SPECIFICATIONS

### ENERGYSAVER® DIRECT VENT WALL FURNACES

	EX08CT (RHFE-202FTA)		EX11CT (RHFE-265FTA)		EX17CT (RHFE-434FTA)		EX22CT (RHFE-559FTA) / EX22CTW (RHFE-559FTA-W)		EX38CT (RHFE-1005FTA) / EX38CTW (RHFE-1005FTA-W)	
<b>Model</b>	EX08CT (RHFE-202FTA)		EX11CT (RHFE-265FTA)		EX17CT (RHFE-434FTA)		EX22CT (RHFE-559FTA) / EX22CTW (RHFE-559FTA-W)		EX38CT (RHFE-1005FTA) / EX38CTW (RHFE-1005FTA-W)	
<b>Fuel Type</b>	NG	LP	NG	LP	NG	LP	NG	LP	NG	LP
<b>Input Range - btu (Low/High)</b>	3,000 / 8,000		5,500 / 11,000		8,200 / 16,700		8,200 / 21,500		13,200 / 38,400	
<b>AFUE Rating</b>	82%		81%		81%		81%		80%	
<b>Dimensions - w, h, d (mm)</b>	18.3 x 27.4 x 10.1 (464.8 x 695.96 x 256.54)		18.3 x 27.4 x 10.1 (464.8 x 695.96 x 256.54)		29.9 x 22.9 x 10.1 (759.4 x 581.6 x 256.54)		29.9 x 22.9 x 10.1 (759.4 x 581.6 x 256.54)		36.6 x 26.4 x 13 (929.6 x 670.5 x 330.2)	
<b>Power Consumption (Electronic Ignition)</b>	41 Watts		44 Watts		46 Watts		56 Watts		117 Watts	
<b>Noise Level db(a)</b>	27 - 36		31 - 38		33 - 38		33 - 42		39 - 46	
<b>Warranty*</b>	10 Year Heat Exchanger, Five Years on Parts, 2 Years on Labor									
<b>Altitude Approved (ft)</b>	10,200 (3,000 m)									
<b>Venting Option</b>	Concentric									

\* For complete information and details regarding Rinnai's warranty and information on sizing guidelines, please visit [rinnai.us](http://rinnai.us).  
NOTE: NG denotes Natural Gas and LP denotes Liquid Propane gas fuel types.



**Rinnai America Corporation**  
103 International Drive | Peachtree City, GA 30269  
1-800-621-9419 | [rinnai.us](http://rinnai.us) | [rinnai.ca](http://rinnai.ca)

PROUD SPONSOR

